

Facility Response Plan 1.7 Evacuation Plan:

Evacuation of non-responding personnel from hazardous substance releases, fires, or any other emergencies should be upwind or crosswind and upgrade. When the emergency alarm is sounded, you must first determine where the emergency is occurring using visual or audible.

All supervisors and muster point leaders must phone into the EOC to provide PAR (Personnel Accountability Report) at extension 6324. Alternate numbers are 6643, 6644, and 6645

DO NOT USE RADIO FOR CONDUCTING PAR!

GUN DRILL PROTOCOL

All refinery personnel are to treat gun drills as a real event!

All vehicles within the process area shall shut down and personnel will proceed to nearest shelter-in-place on foot.

EXCEPTION! All critical operations and maintenance activities may continue with the approval of the BP area supervisor.

Always know your wind direction!

Emergency Notifications! Dial 6911 on plant phone for P4 or EOC! Dial 419-567-6911 from outside plant. Use primary radio assigned radio channel to declare emergency if phone is not available.

1. Declare "Emergency, Emergency, Emergency"
2. Identify yourself
3. Describe the emergency
4. Give the location of the emergency
5. Provide important details



Refinery Evacuation Map.pdf

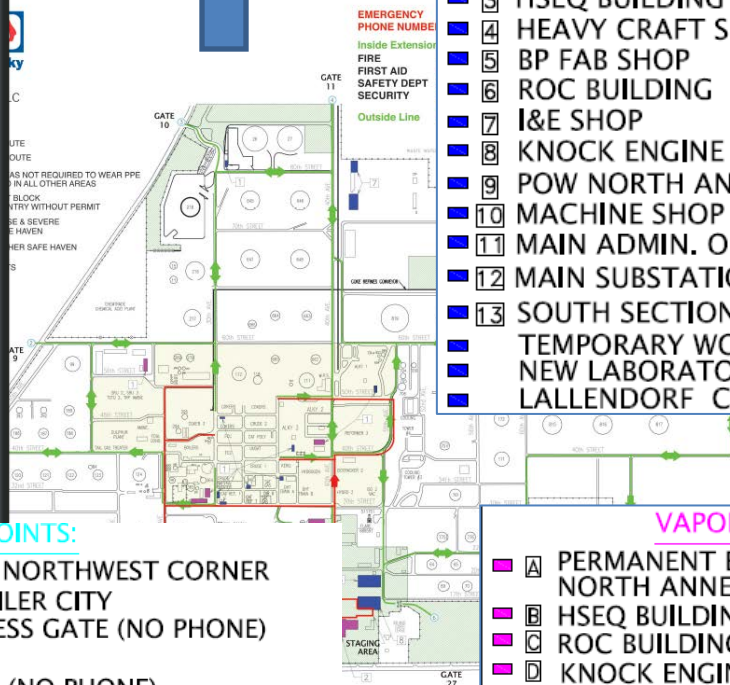

SEVERE WEATHER SAFE HAVENS:

- 1 PERMANENT BLAST PODS. (NORTH, NORTH ANNEX, SOUTH, EAST, WEST)
- 2 SIGN-IN PODS
- 3 HSEQ BUILDING
- 4 HEAVY CRAFT SHOP
- 5 BP FAB SHOP
- 6 ROC BUILDING
- 7 I&E SHOP
- 8 KNOCK ENGINE LAB
- 9 POW NORTH AND SOUTH AND MIDDLE
- 10 MACHINE SHOP
- 11 MAIN ADMIN. OFFICE BUILDING
- 12 MAIN SUBSTATION BASEMENT
- 13 SOUTH SECTION OF WAREHOUSE
- TEMPORARY WORK CAMP/TAR ACTIVITY
- NEW LABORATORY
- LALLENDORF COMPLEX

MUSTER POINTS:

- 1 GATE 6 – PARKING LOT NORTHWEST CORNER
- 2 GATE 9/9B – NEAR TRAILER CITY
- 3 GATE 11 – NORTH ACCESS GATE (NO PHONE)
- 4 GATE 17 – TRAILERS
- 5 GATE 23-B – FIRE FIELD (NO PHONE)
- 6 GATE 27 – CONTRACTOR'S PARKING LOT

VAPOR RELEASE SAFE HAVENS:

- A PERMANENT BLAST PODS. (NORTH, NORTH ANNEX, SOUTH, EAST, WEST)
- B HSEQ BUILDING
- C ROC BUILDING
- D KNOCK ENGINE LAB
- E MAIN ADMIN. OFFICE BUILDING (2 STORY)
- F POW MIDDLE